

A	B	C (mm)			D
1	S378-0014	1804	416	19	3/4
2	S378-0015	1804	416	19	3/4
3	S378-1017	1834	542	16	1/4
4	S378-1018	1834	542	16	1/4
5	S378-2008	998	565	36	2/4
6	S378-3018	933	542	16	2/4
7	S378-3019	933	522	22	2/4
8	S378-4006	933	44	16	2/4
9	S378-5001	1914	80	16	4/4
10	S378-5002	1914	80	16	4/4
11	S378-5005	80	60	16	4/4
12	S378-5019	1951	80	30	4/4
13	S378-5020	1951	80	30	4/4
14	S378-9310	1846	943	2,5	1/4
15	dr-929	929	30	15	2/4

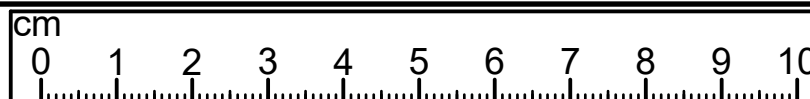

8x a132	4x a133	8x b43	2x c468	8x d37	16x Ø6.3x13 mm e2	8x Ø7x28 mm e22	20x Ø8x30 mm f1	6x Ø8x20 mm f13	2x Ø10x50 mm f35	6x k1	18x l2	2x 86x21x151.5 n142
2x n158	2x Ø3.5x13 mm p1	2x Ø5x60 mm p17	42x Ø3.5x16 mm p38	16x Ø3.5x15 mm p51	4x Ø4x12 mm p59	14x Ø15x12 mm #16 r1	6x Ø15x15 mm #22 r3	20x 20/11 r42	8x s1	12x Ø16 s2	1x 4 mm z1	

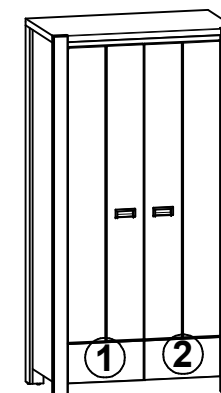
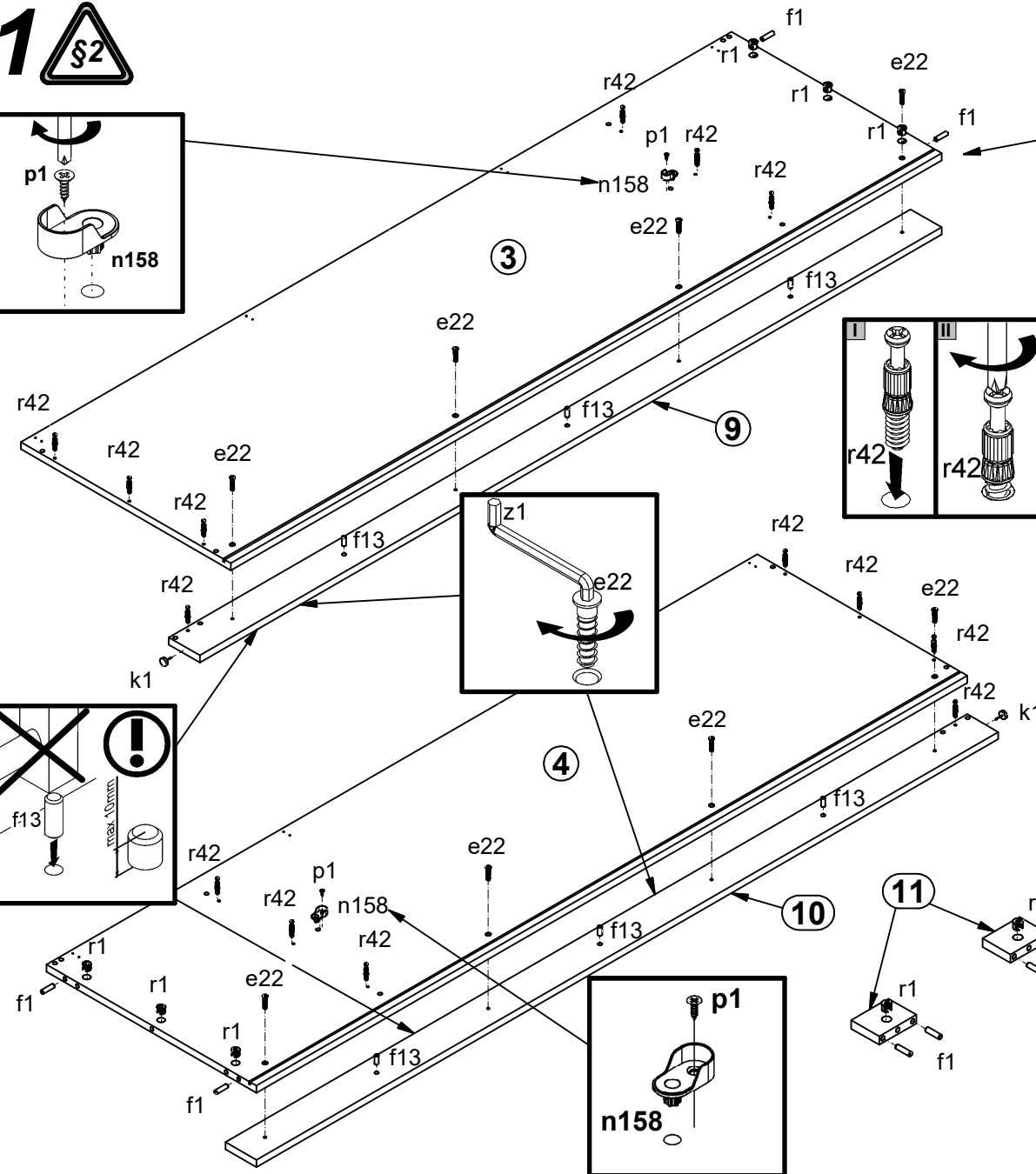
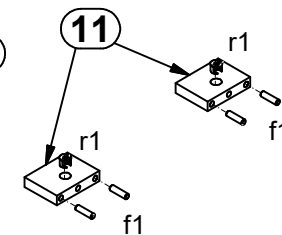
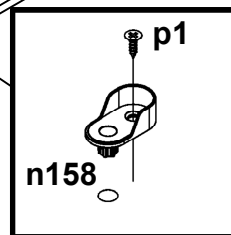
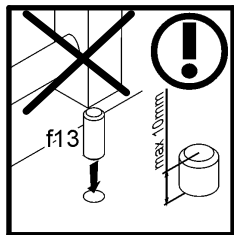
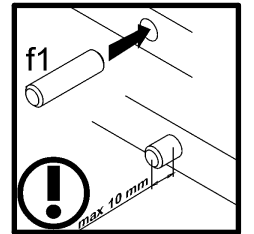
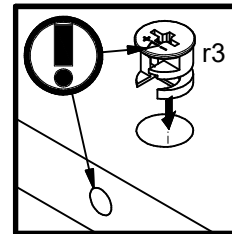
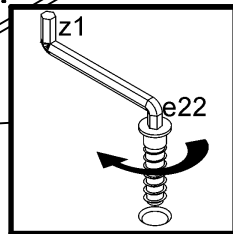
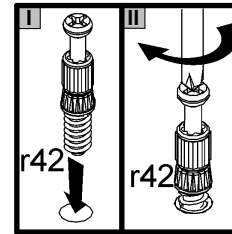
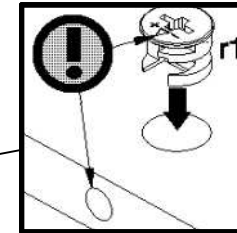
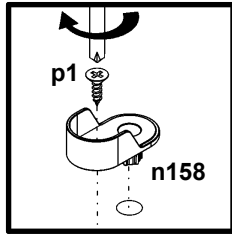

8x Ø7x28 mm e22	16x Ø6x30 mm f1	6x Ø8x20 mm f13	2x k1	2x n158
2x Ø3,5x13 mm p1	14x Ø15x12 mm #16 r1	6x Ø15x15 mm #22 r3	14x 20/11 r42	1x 4 mm z1

2 §2

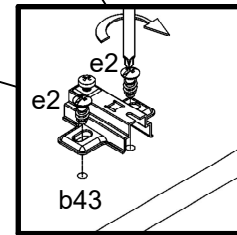
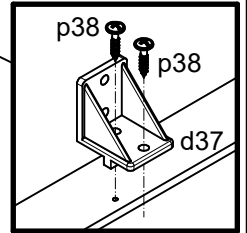
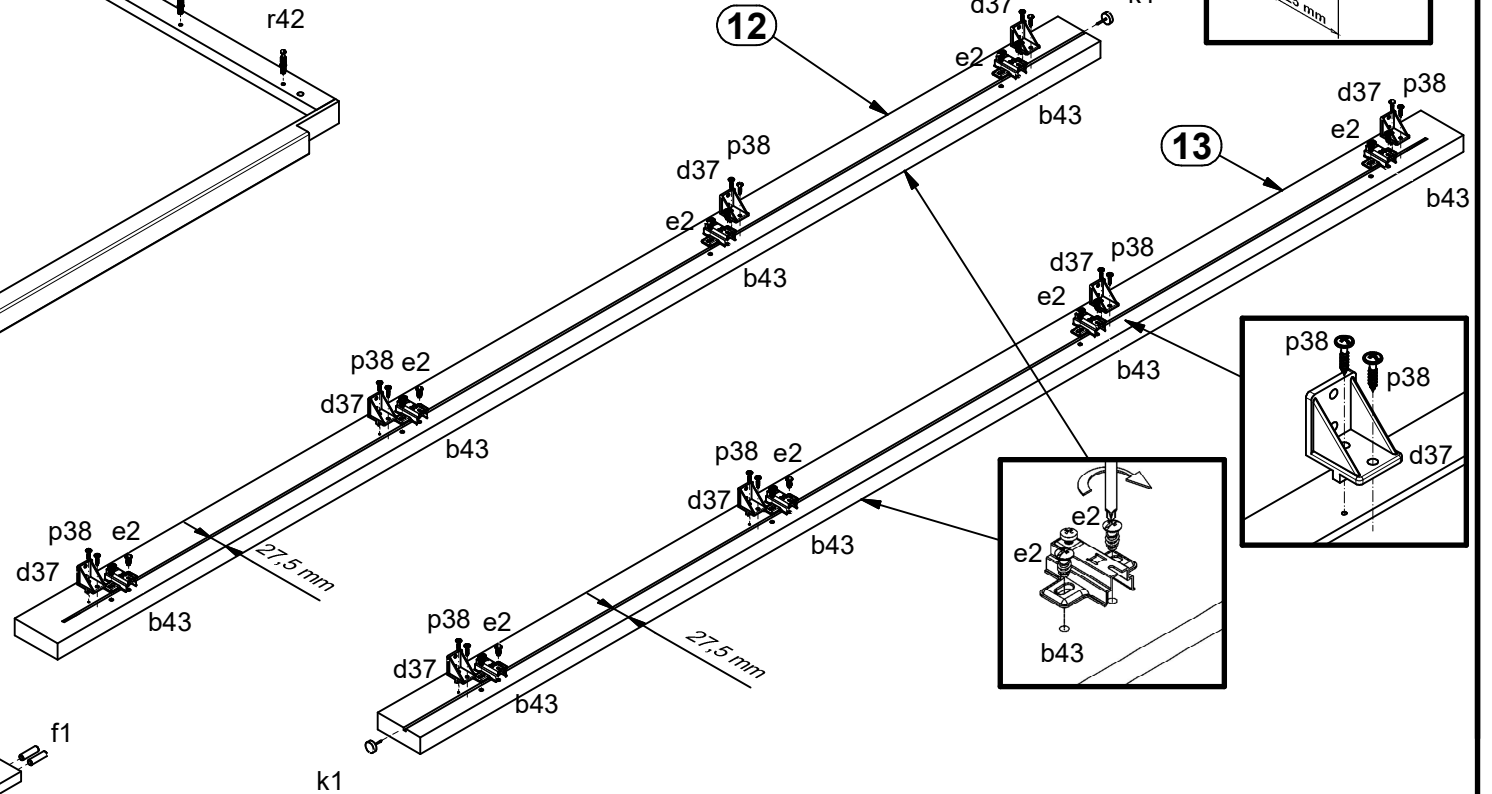
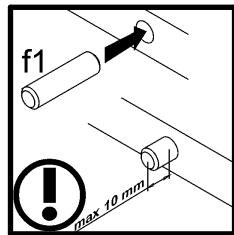
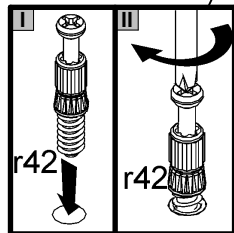
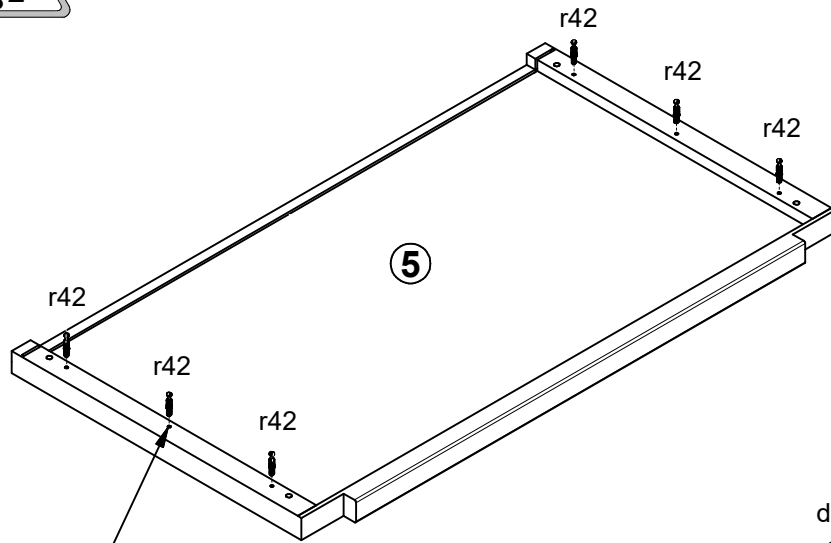
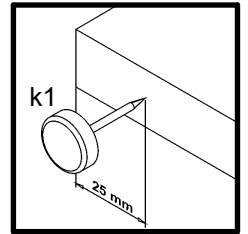

- 8x **b43**
- 8x **d37**
- 16x **e2**
Ø6,3x13 mm
- 4x **f1**
Ø8x30 mm
- 2x **k1**
- 16x **p38**
Ø3,5x16 mm
- 6x **r42**
20/11

3 

4

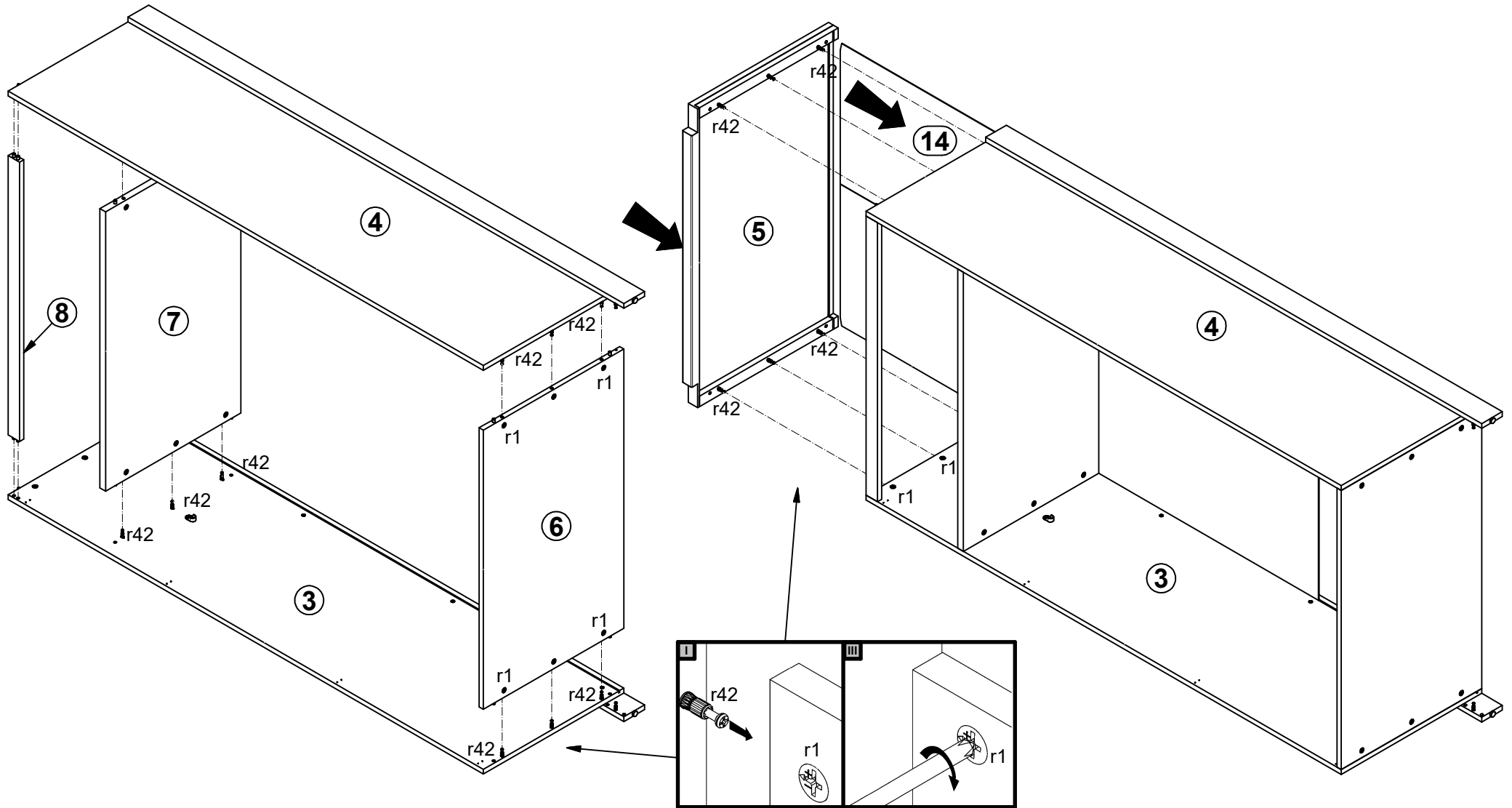

5

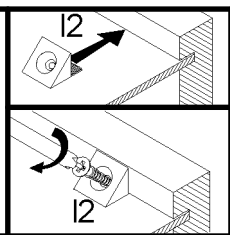
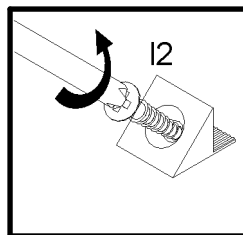
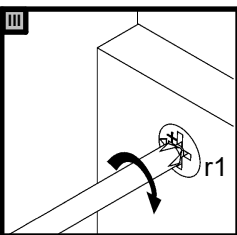
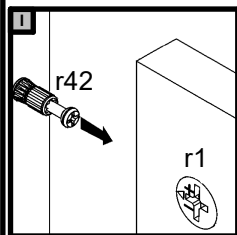
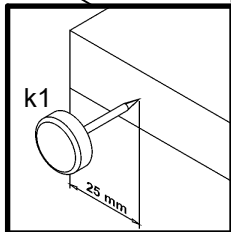
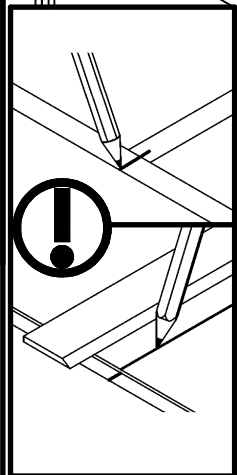
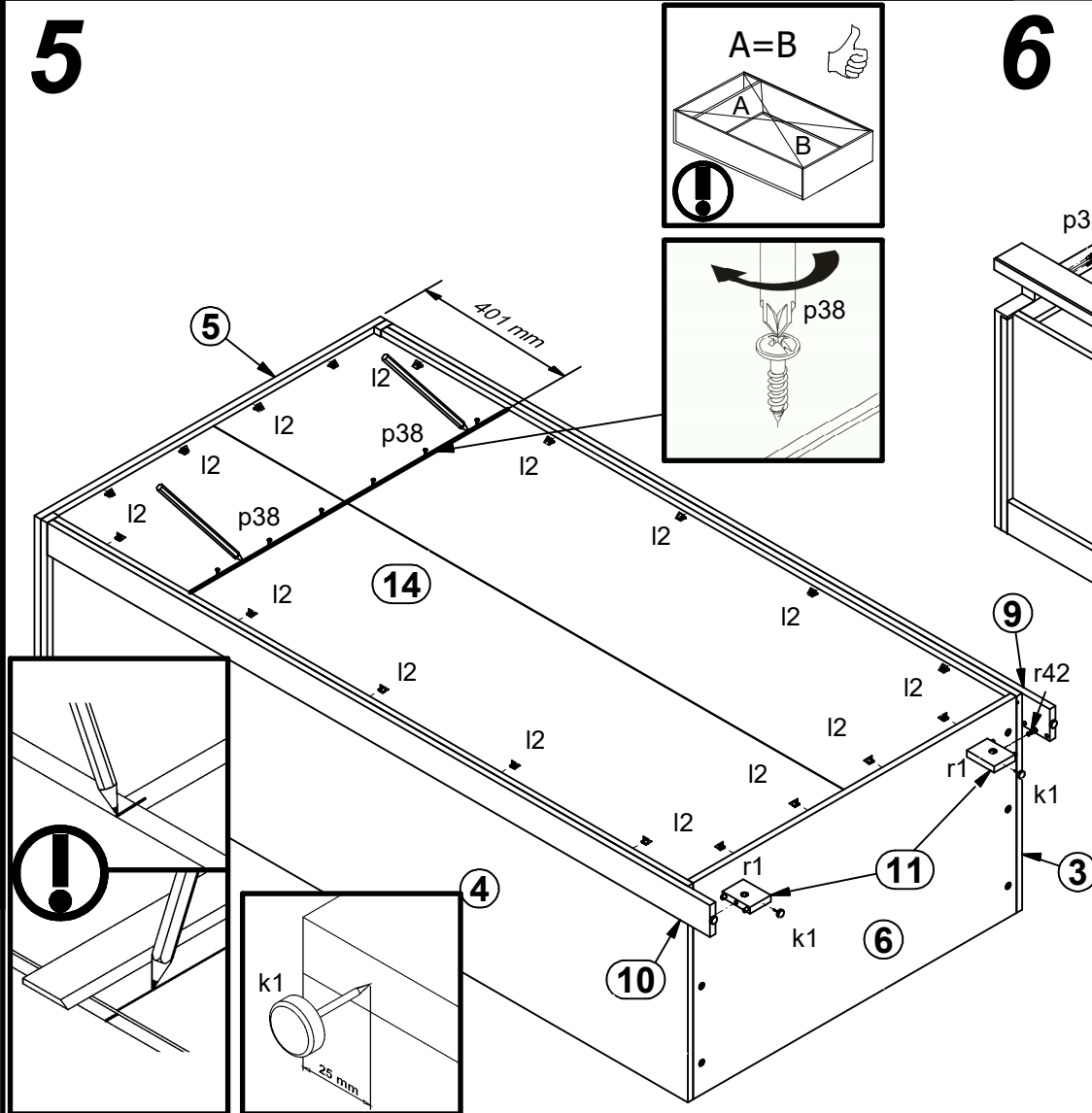



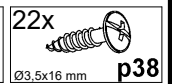
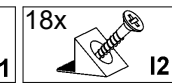
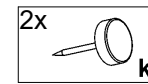
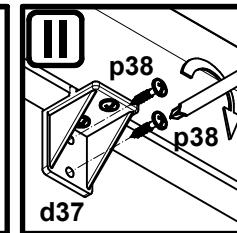
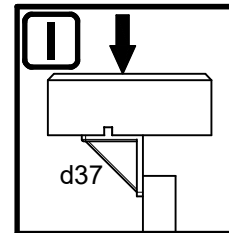
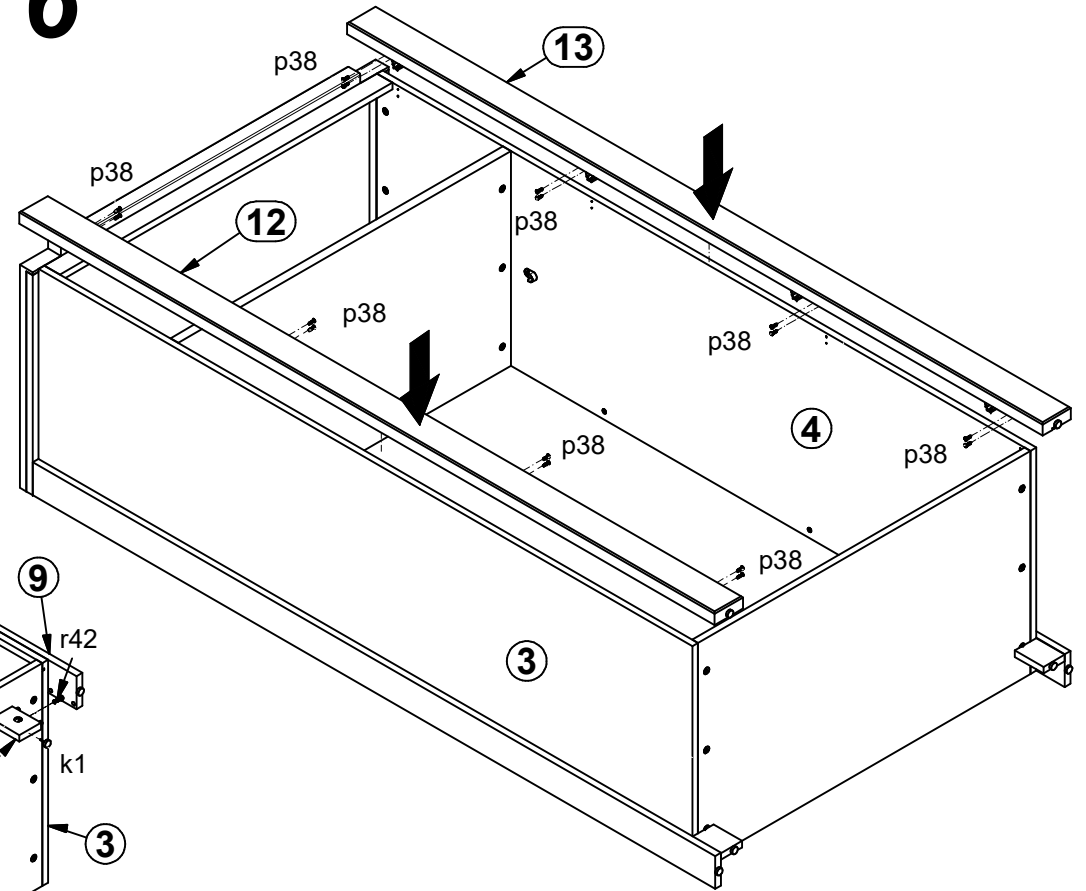

6

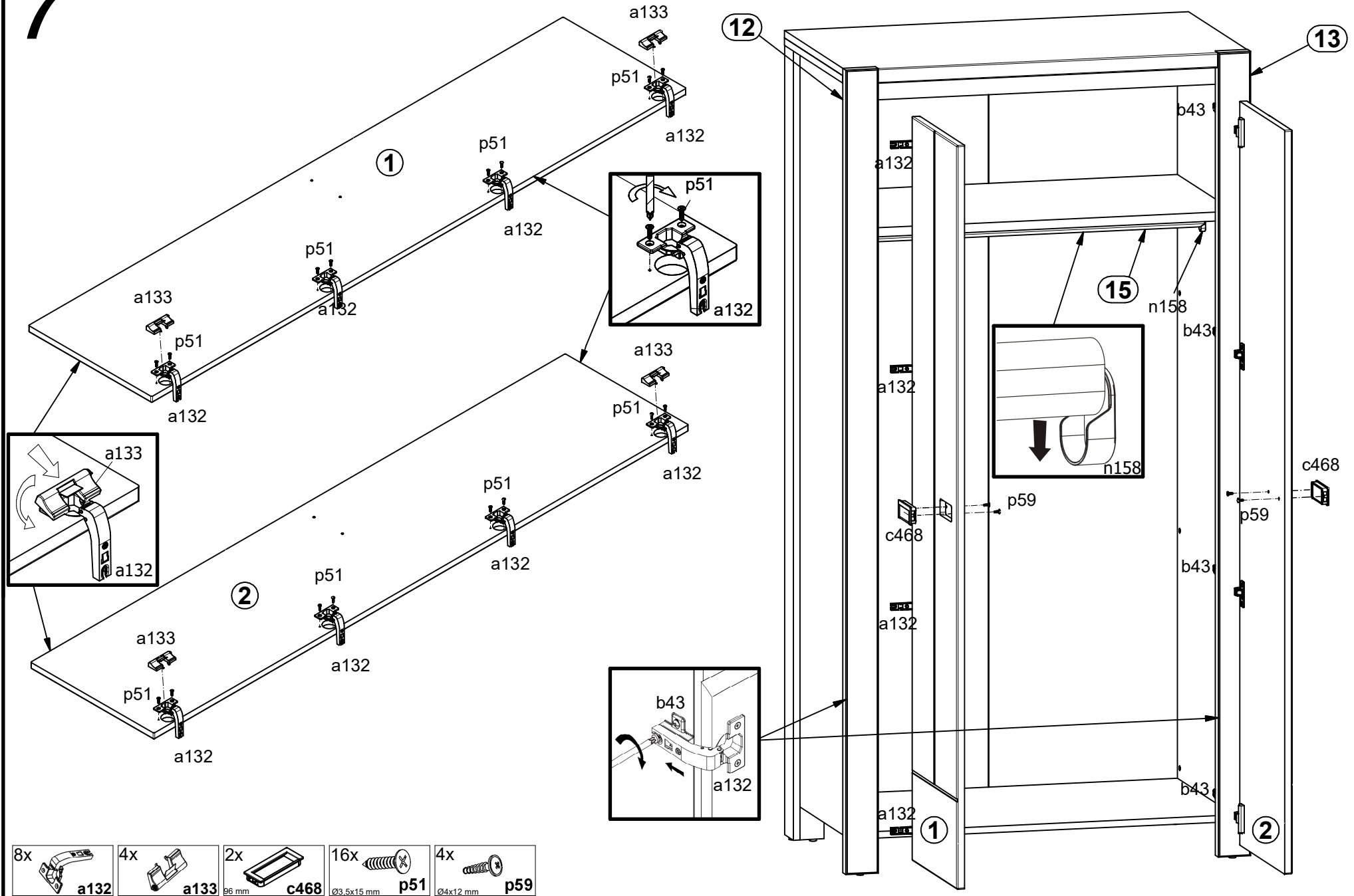

7

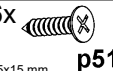

- 8x  a132
- 4x  a133
- 2x  c468 96 mm
- 16x  p51 Ø3.5x15 mm
- 4x  p59 Ø4x12 mm

8

