



www.MLMEBLE.pl

GB D CZ SK RUS LT
assembly instructions / montageanleitung / montážní návod / montážny návod / инструкции по монтажу / surinkimo instrukcija



INSTRUKCJA MONTAŻU

BALTICA 04/S
140 138 43

akcesoria / accessories / zubehör / příslušenství / prislušenstvo / аксессуары / furnitūra :

x 48 KK 8/32	x 10 WT 4x30	x 59 BMD	x 13 ZAM	x 18 WT 3,5x16	x 4 MD2 L68	x 43 ZMD	x 20 PO Ø5	x 1 klej / glue / kleber / lepidlo / lepidlo / klijai / klijai	x 16 BDP	x 30 GZ 1,4/25
x 11 SP	x 8 SG 8/8	x 1 kluczyk / key / schlüssel / klíč / kľúč / ключ / raktas	x 4 KK 8/60	x 4 ZPR	x 4 PK H-2	x 5 UT 1.151 M47	x 8 WE 6,3x13 B	x 4 MD2 L76	x 2 PK H-0	x 2 ZA 45°
x 12 TD 01	x 30 WTLP 3x16	x 12 WE 6,3x13ES	x 12 WE 6,3x16ES	x 2 PK L-350	x 1 LT	x 1 PK 25	x 1 PKZ	x 4 WE 6,3x24	x 2 DPP 02	

do montażu potrzebne są:
are needed for assembly:
sind erforderlich für die montage:
jsou potřebné pro montáž:
sú potrebné pre montáž:
которые необходимы для сборки:
Surinkimui reikės

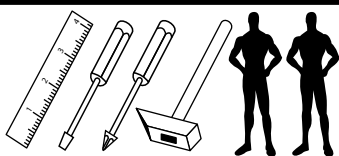

UWAGA! - w pierwszej kolejności wbijamy akcesoria „KK” i „MD” w blaty oraz boki.
WARNING! - The first accessory sticks "KK" and "MD" in the tops and sides.
WARNUNG! - Die erste Accessoire-Sticks "KK" und "MD" in den Spitzen und an den Seiten.
POZOR! - První příslušenství holi "KK" a "MD" v korunách a boky.
POZOR! - Prvé príslušenstvo palíc "KK" a "MD" v korunách a boky.
ВНИМАНИЕ! - Первый аксессуаров палочки "KK" и "MD" по вершинам и по бокам.
DĚMESIO! - Pirmiausiai furnitūrą KK ir MD įkalame į stalviršį ir šonus.

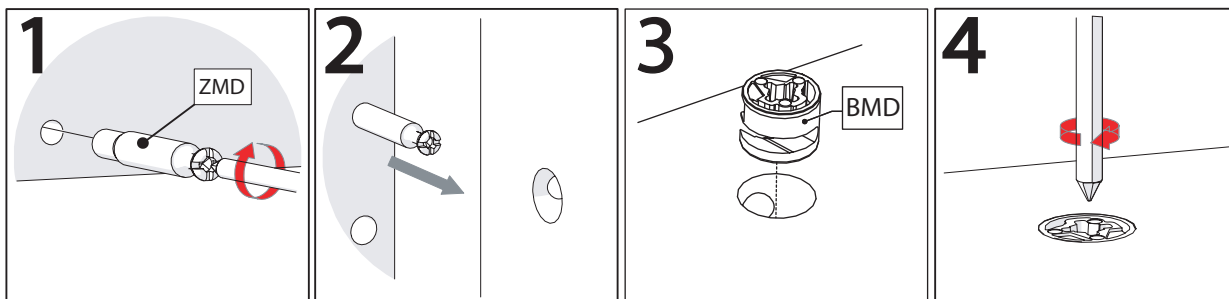

Name	BOM ID	Qty
Baltica04s_01	1	1
Baltica04s_02	2	1
Baltica04s_03	3	1
Baltica04s_04	4	1
Baltica04s_05	5	1
Baltica04s_06	6	1
Baltica04s_07	7	2
Baltica04s_08	8	2
Baltica04s_09	9	2
Baltica04s_10	10	1
Baltica04s_11	11	1
Baltica04s_12	12	1
Baltica04s_13	13	1
Baltica04s_14	14	1
Baltica04s_15	15	2
Baltica04s_16	16	2

Name	BOM ID	Qty
Baltica04s_17	17	2
Baltica04s_18	18	2
Baltica04s_19	19	1
Baltica04s_20	20	1
Baltica04s_21	21	1
Baltica04s_22	22	1
Baltica04s_23	23	1
Baltica04s_24	24	2
Baltica04sHDF_01	25	2
Baltica04sHDF_02	26	2
Baltica04sHDF_03	27	2
D_szklo	28	2
P_szklo	29	4
P_szklo	30	1

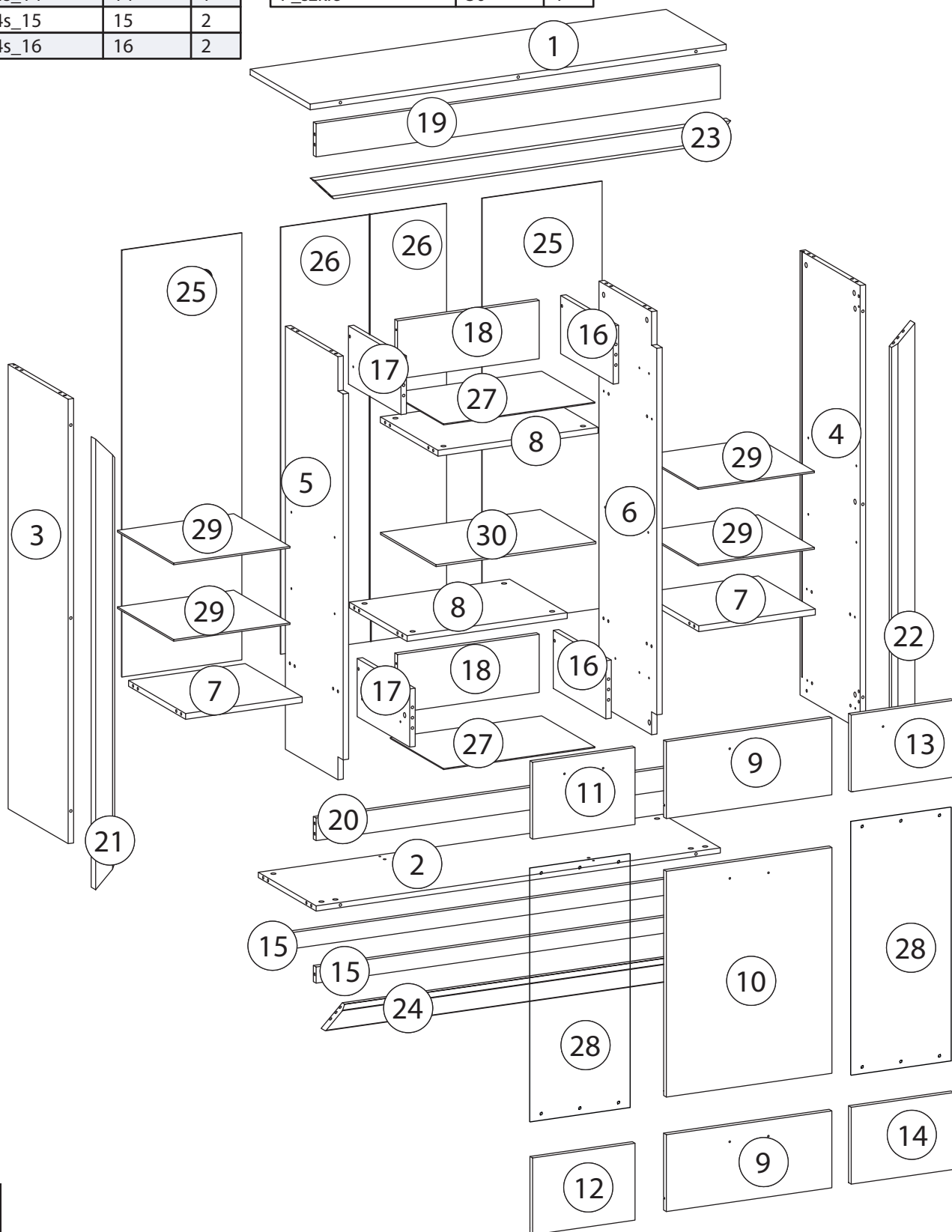

UWAGA! - Wypinanie prowadnicy
WARNING! - guides disassembling
WARNUNG! - Ausstecken Führer
POZOR! - vytažení pojezdů
POZOR! - sprievodca pre montáž nábytku
ВНИМАНИЕ! - демонтаж направляющих
DEMESIO! - İsrinkimas atskyrimas

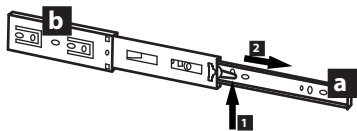

1 ▶

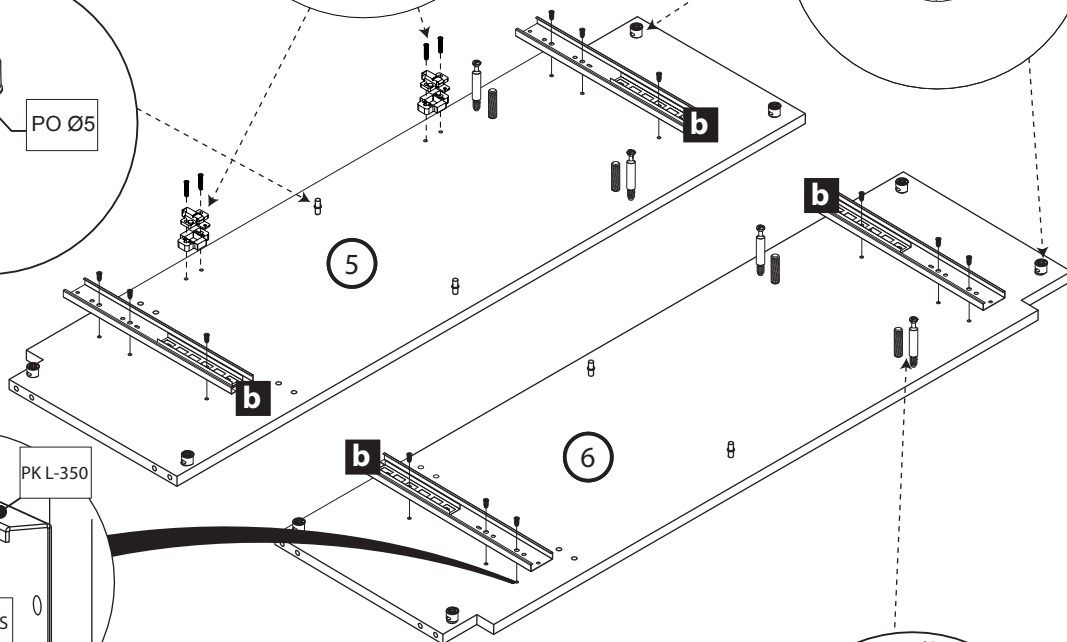
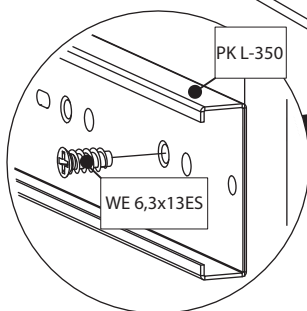
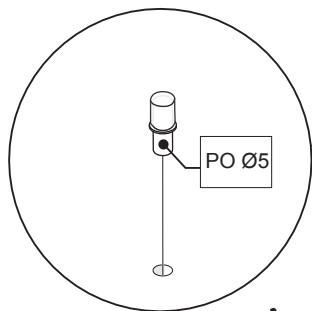
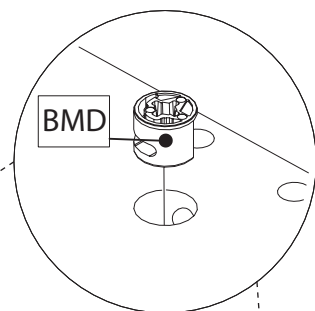
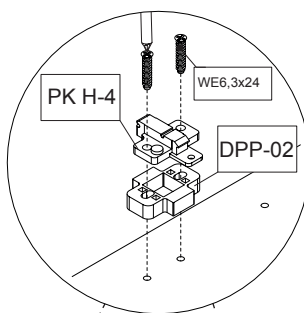

2 ▶

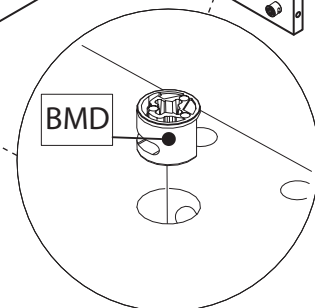
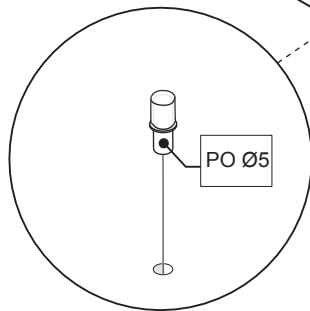
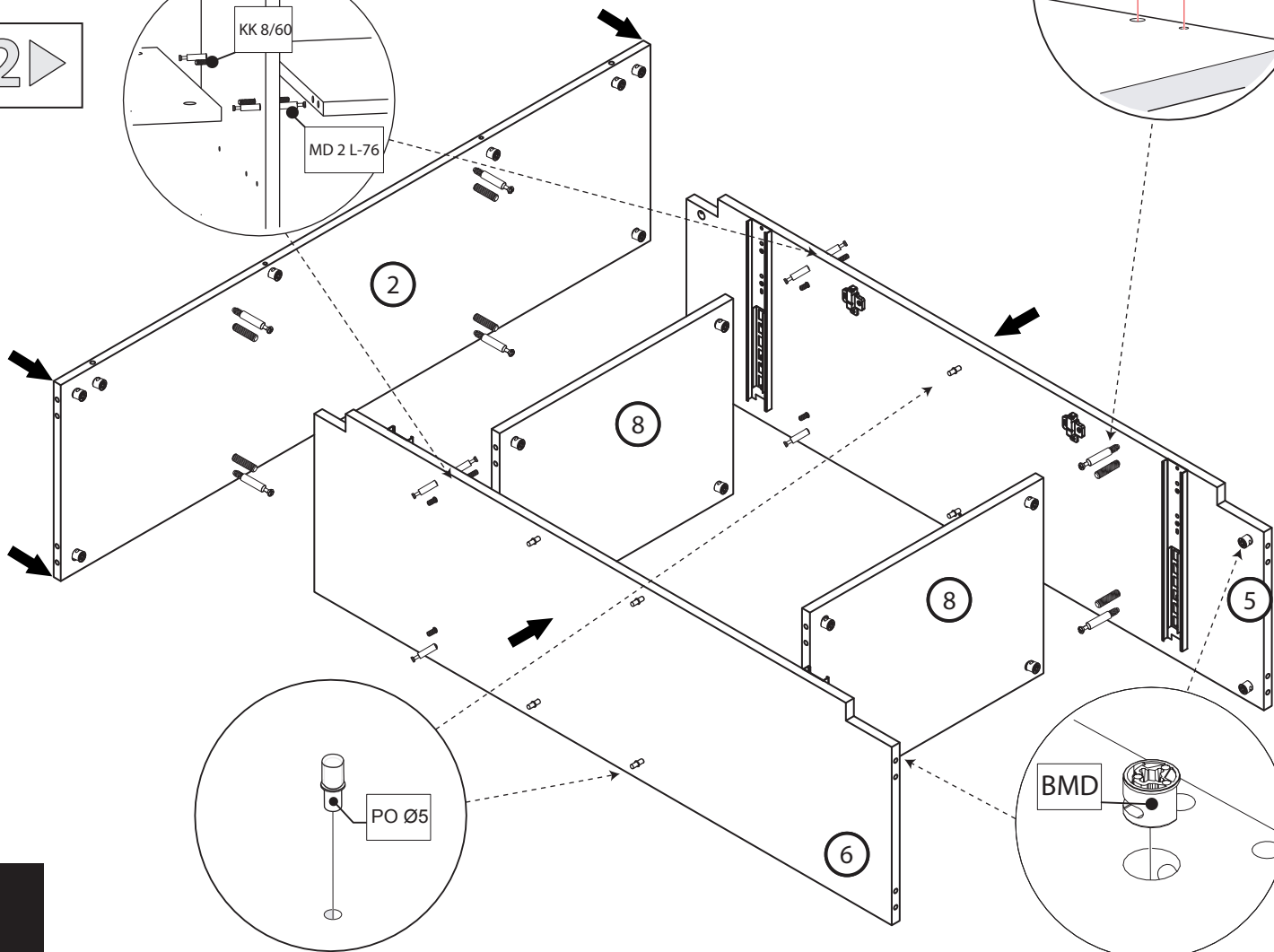
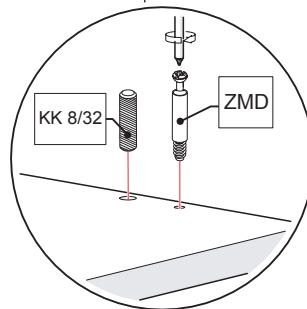
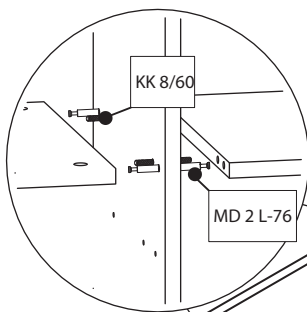

3

3 ▶

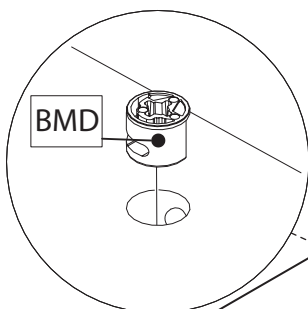
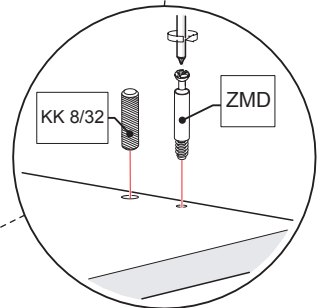
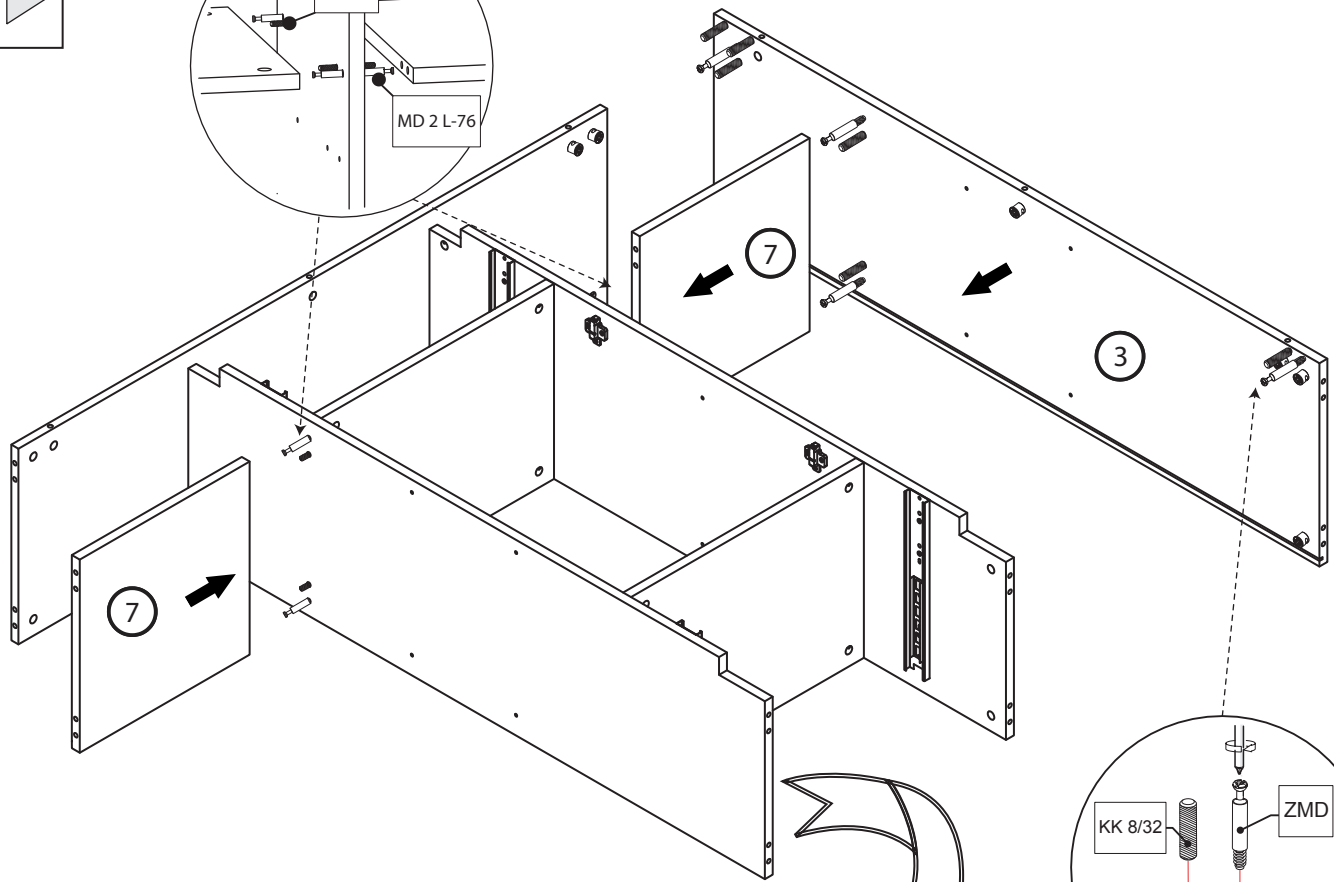
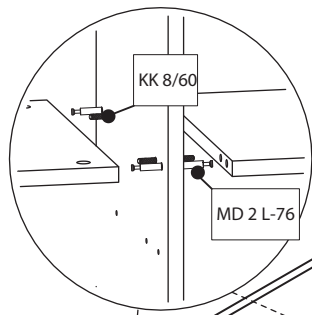

4 ▶

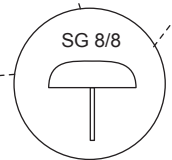
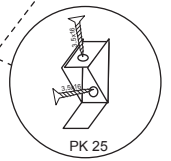
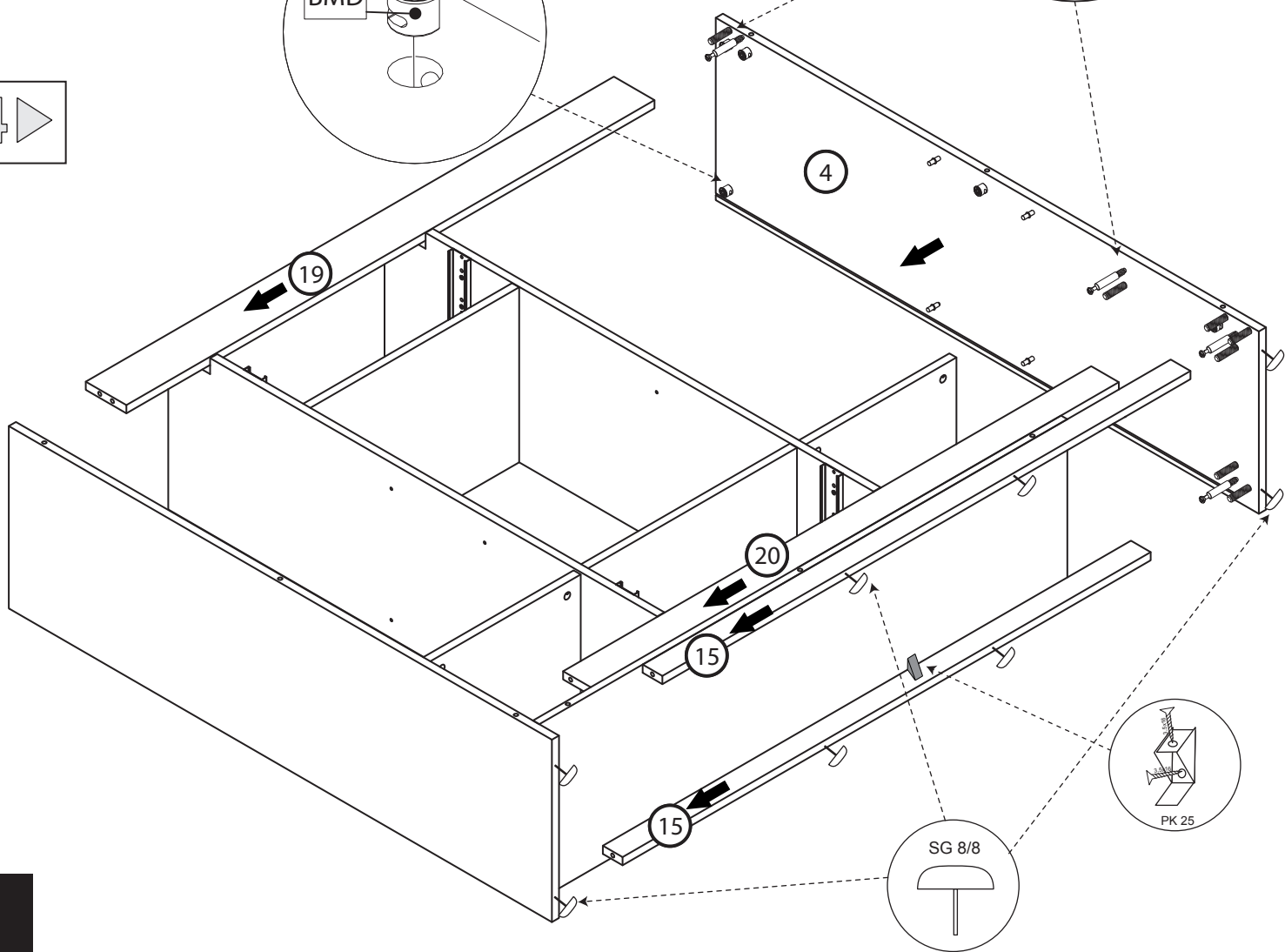

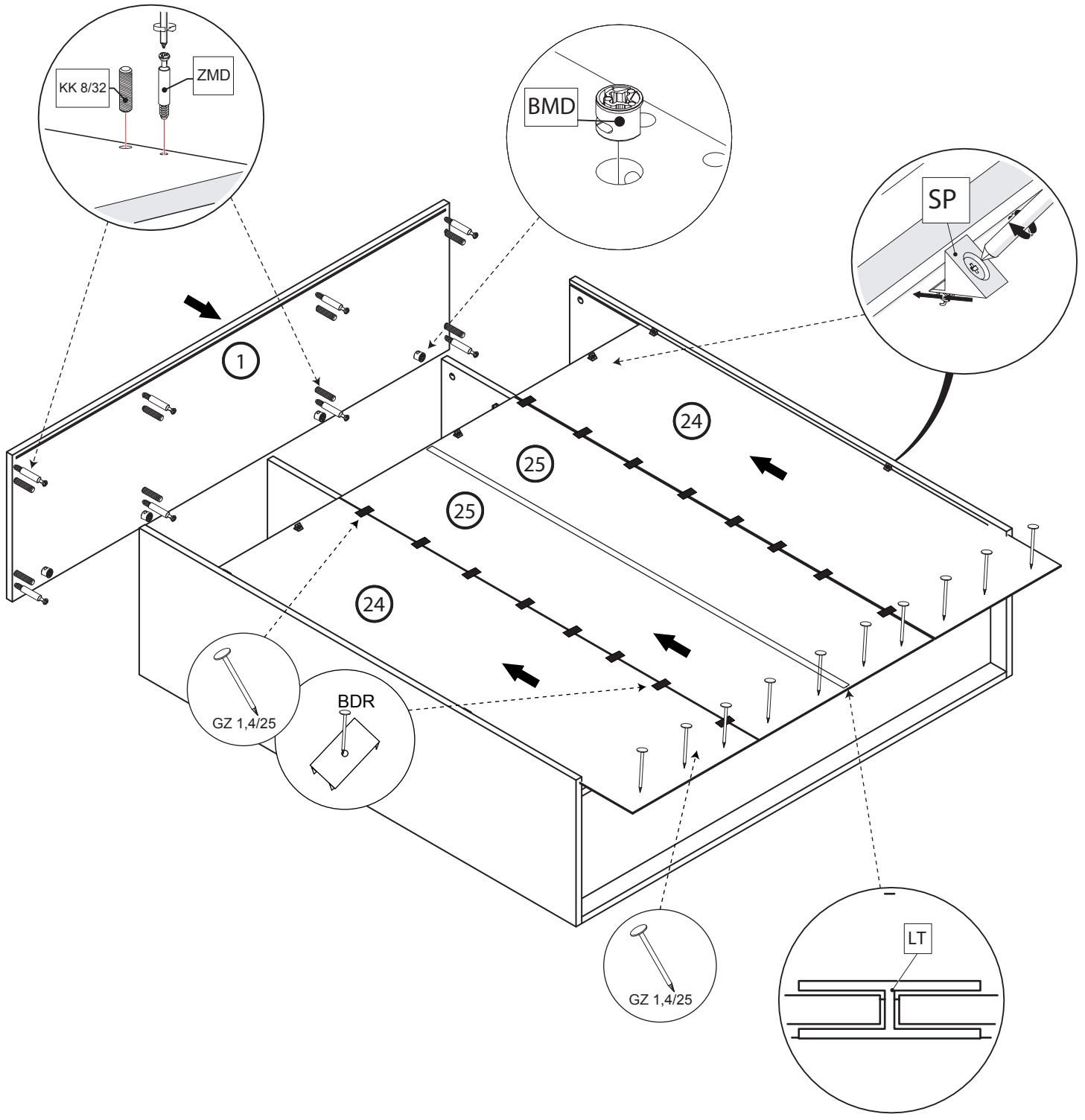

6 ▶

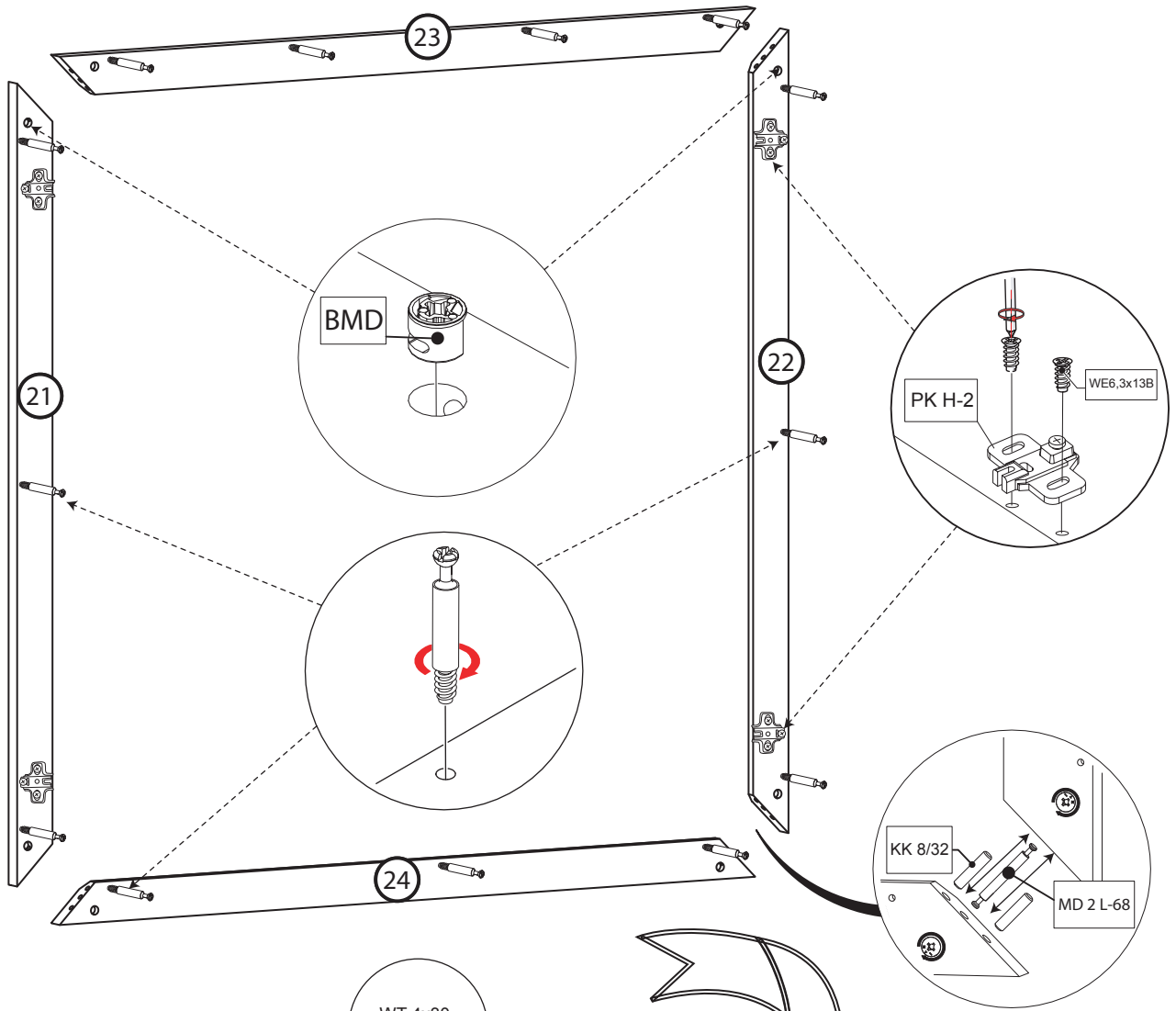

7 ▶

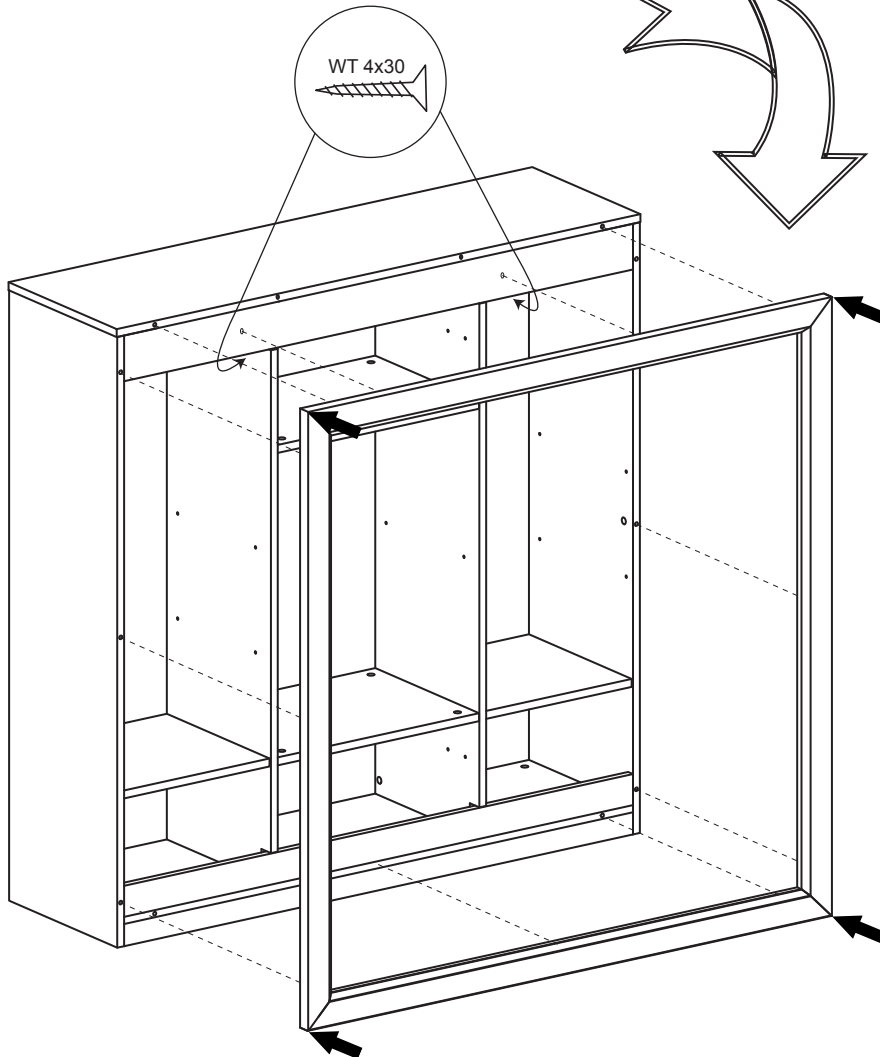

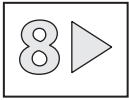

! UWAGA! - Wypinanie prowadnicy
WARNING! - guides disassembling
WARNUNG! - Ausstecken Führer
POZOR! - vytažení pojezdů
POZOR! - spríevodca pre montáž nábytku
ВНИМАНИЕ! - демонтаж направляющих
DĒMESIO! - Išrinkimas atskyrimas

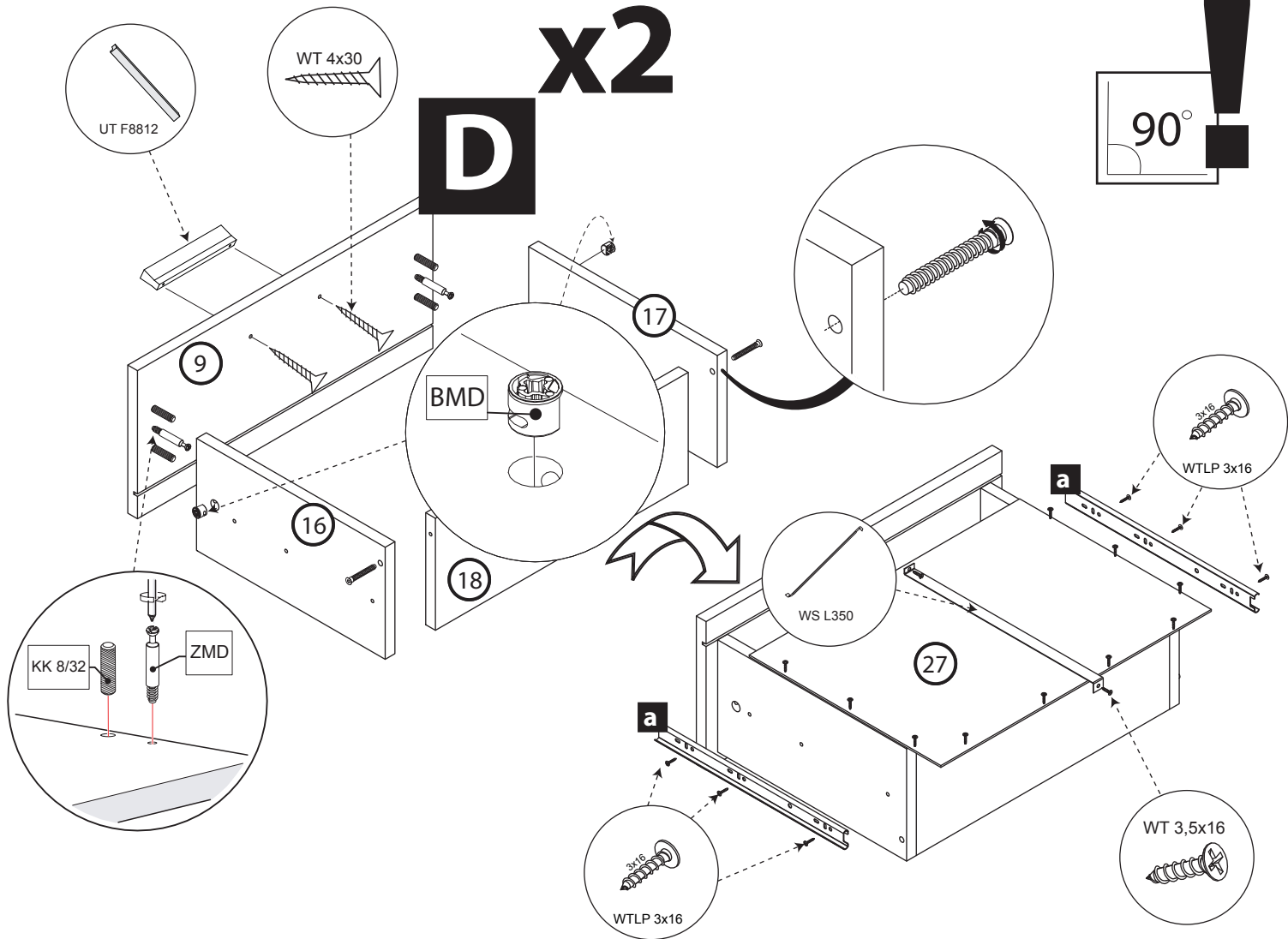
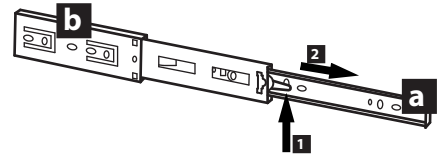

9 ▶

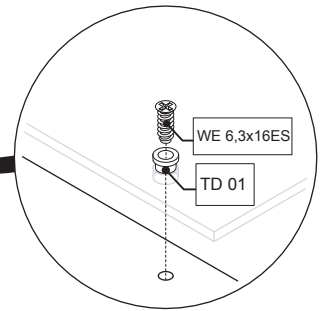
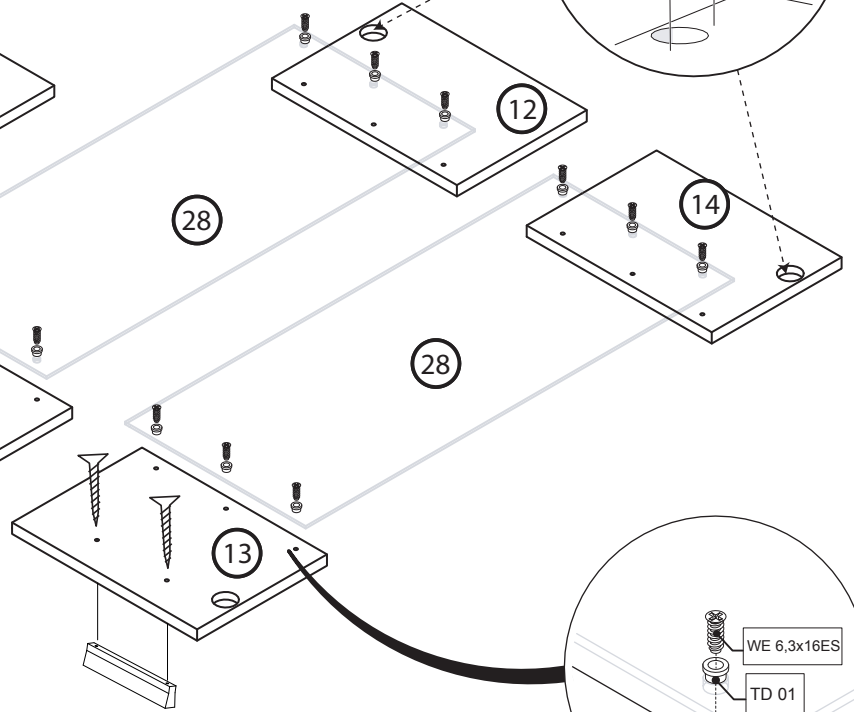
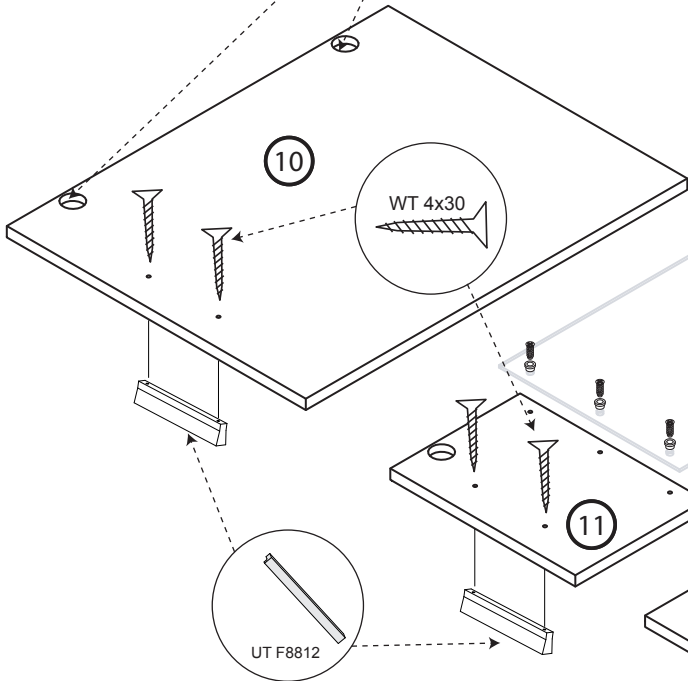
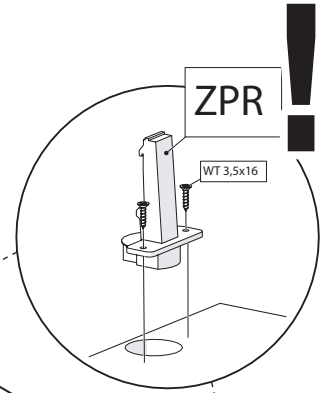
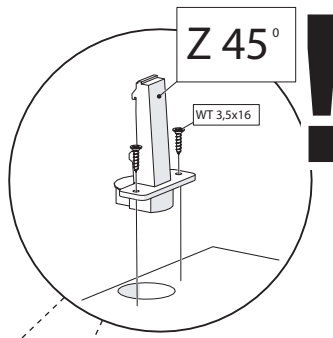

10 ▶

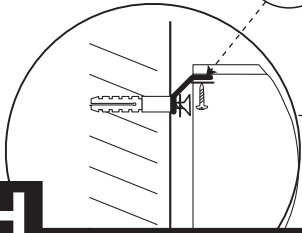

H
UWAGA! - Mocowanie do ściany.
WARNING! - Attaching to the wall.
WARNUNG! - Anbringen an der Wand.
POZOR! - Připevnění na stěnu.
POZOR! - Připevnění na stěnu.
ВНИМАНИЕ! - Крепление к стене.
DĚMESIO! - Tvrtinimas prie sienos.

